

# Technical data sheet

## Clamp clip, single, plastic pressure trough

Art.-Nr. 1175580



Suitable for all C profile rails with slot width 18 mm and 22 mm.  
Polypropylene pressure sleeve, halogen-free, colour light grey RAL 7035.



St	Steel
FT	Hot-dip galvanised

### Master data

Item no.	1175580
Type	2056U 58 FT
Description 1	Clamp clip
Dimension	52-58mm
Material	Steel
Material symbol	St
Surface	Hot-dip galvanised
Surface to DIN	DIN EN ISO 1461
Surface symbol	FT
Smallest sales unit	100,00 Piece
Weight	13,40 kg/100 pc.

# Technical data sheet

## Clamp clip, single, plastic pressure trough

Art.-Nr. 1175580



### Technical data

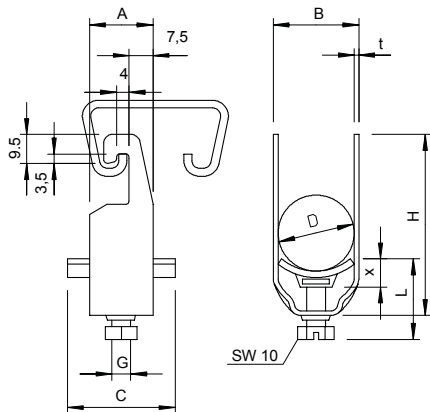

Dimension A	23,00 mm
Dimension B	64,00 mm
Dimension C	40 mm
Dimension G	M8
Dimension H	91,00 mm
Dimension L	38,50 mm
Dimension t	2,50 mm
Dimension x	6,50 mm
Number of cables/pipes	1,00
Max. tightening torque	5,00 Nm
for 1 cable H	91,00 mm
for 1 cable L	38,50 mm
for 2 cable H	152,00 mm
for 2 cable L	45,50 mm
for pipe diameter	50 mm
for rail with slot width	18,00 - 22,00 mm
Halogen-free	<input checked="" type="checkbox"/>
With plastic trough	<input checked="" type="checkbox"/>
With metal trough	<input type="checkbox"/>
Mounting type	Profile rail
Impact-resistant	<input type="checkbox"/>
Clamping range D	52,00 - 58,00 mm
Surface addition	hot galvanised
Material addition	Steel