

# Premolded screened separable cable connectors

## CSE-A 12–24 kV, 250 A

## CSS-A 12–24 kV, 250 A

### Application areas

Premolded screened separable connectors for XLPE- and EPR-insulated 1- or 3-core cables with Al- or Cu-conductors for 12–24 kV. Can be installed both indoors and outdoors.

Fits standard bushings of outer cone type according to EN 50181. Connector with rated current:

- 250 A: Interface A with plug-in  $\varnothing$  7.9 mm.

### Standard

Meets the requirements of:

- CENELEC, HD 629.1 S2

### Design

CSE-A and CSS-A are manufactured in rubber with three layers; a conductive inner layer, an insulation layer and a conductive outer layer, that are vulcanized together for the best possible interface between the layers.

The cable connectors include both a capacitive test point with protection and an integrated earthing wire.

- Delivered in 3-phase kits, complete with cable lugs, bolt connection and stress grading adapter, designed to ensure a reliable installation.

### Note:

- For 3-core cable with common copper screen wires, a screen separation kit or a branch seal kit must be used. To be ordered separately.

Always select products by cable insulation diameter.



CSE-A 12250  
CSE-A 24250

CSS-A 12250  
CSS-A 24250

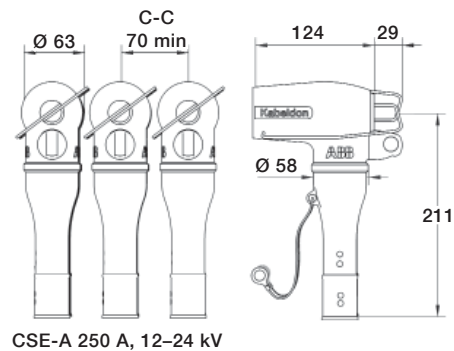

CSE-A 250 A, 12–24 kV

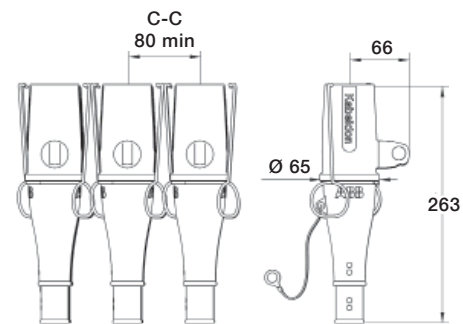

CSS-A 250 A, 12–24 kV

Voltage	Insulation diameter	Conductor cross section	Designation	Rated current	Weight
				A	kg/unit
<b>Elbow cable connector</b>					
12	10–12	10–16	CSE-A 12250-01	250	2.2
12	13–22	25–95	CSE-A 12250-02	250	2.2
<b>Elbow cable connector</b>					
24	13–22	10–16	CSE-A 24250-01	250	2.2
24	17–25.5	25–95	CSE-A 24250-02	250	2.2
<b>Straight cable connector</b>					
12	10–12	10–16	CSS-A 12250-01	250	2.2
12	13–22	25–95	CSS-A 12250-02	250	2.2
<b>Straight cable connector</b>					
24	13–22	10–16	CSS-A 24250 01	250	2.2
24	17–25.5	25–95	CSS-A 24250 02	250	2.2

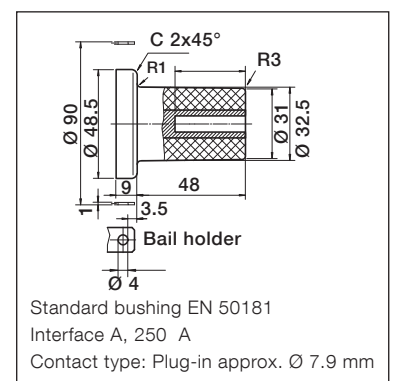

# Premolded screened separable connector for cables with Cu-tape screen CSE-A 12–24 kV, 250 A

## Application areas

Premolded screened separable connectors for XLPE- and EPR-insulated 1- or 3-core 12–24 kV cables with Al- or Cu-conductors with copper tape screens, with or without aluminium or steel wire armouring. Can be installed both indoors and outdoors.

3

Fits standard bushings of outer cone type according to EN 50181. Connector with rated current:

- 250 A: Interface A with plug-in  $\varnothing$  7.9 mm.

## Standard

Meets the requirements of:

- CENELEC, HD 629.1 S2

## Design

CSE-A is manufactured in rubber with three layers; a conductive inner layer, an insulation layer and a conductive outer layer, that are vulcanized together for the best possible interface between the layers. The cable connectors include both a capacitive test point with protection and an integrated earthing wire.

Delivered in 3-phase kits, complete with cable lugs, bolt connection, earthing kit and stress grading adapters. The adapters are designed to ensure a reliable installation.

For 3-core cables, a branch seal kit is included.



CSE-A 12250  
CSE-A 24250

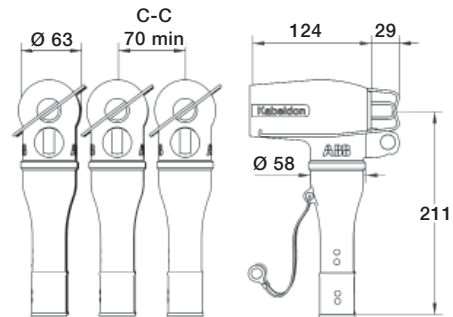

CSE-A 250 A, 12–24 kV

Always select products by cable insulation diameter.

Voltage kV	Insulation diameter mm	Conductor cross section mm <sup>2</sup>	Designation	Outer sheath	Weight
				diameter mm	kg/unit
<b>Elbow cable connector, 3 x 1-core</b>					
12	13–22	25–95	CSE-A 12250-02 R	–	2.7
<b>Elbow cable connector, 3 x 1-core</b>					
24	19–25.5	35–95	CSE-A 24250-02 S	–	2.7
<b>Elbow cable connector, 3-core</b>					
12	13–22	25–50	CSE-A 12250-02 RA	31–50	2.9
12	13–22	70–95	CSE-A 12250-02 RB	44–70	2.9
<b>Elbow cable connector, 3-core</b>					
24	19–25.5	35–95	CSE-A 24250-02 SB	47–70	2.9

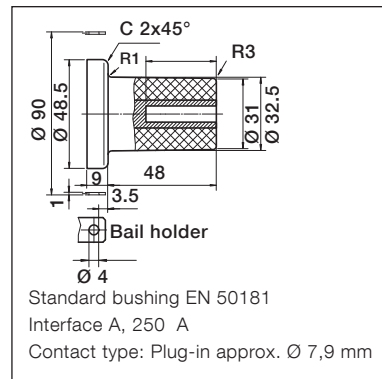

# Accessories, to be ordered separately

## Screened separable cable connectors CSE-A and CSS-A 12–24 kV, 250 A



### IH-A 24250

Insulating hood of flexible rubber with outer conductive layer and a preinstalled insulating rod. To be mounted on the bushing in a switchgear or a transformer 250 A to insulate it when a cable is temporarily disconnected but other cables are energized.



### PSSK

Screen separation kit to achieve a metallic screen on each core for 3-core cables.



### JP 250

Earth circuit connector for short-circuit protective earthing. For mounting on the disconnected connector CSE-A for 250 A.



### IP 250

Screened insulating plug for installation in the connector so that the cable can be energized even when disconnected from the switchgear or transformer 250 A.



### TSH

Branch seal kit to achieve a sealing on each core for 3-core cables.



### CU 250

Coupling piece to connect two connectors.



### PC 630/250

Parallel coupling piece. Replaces the plug in CSE-A 630 A when making a parallel connection to CSE-A 250 A. Delivered in 3-phase kits and hex bit socket.



### MA 250

Measurement adapter used for mega ohm  $\Omega$  measurements and to perform different measurements up to 5 kV DC, for example determination of phases, 250 A.

Designation	Description	Qty. per kit	Weight	See page
			kg/kit	
IH-A 24250	Insulating hood, 12–24 kV, 250 A	3	2.3	3/16
IP 250	Screened insulating plug, 250 A	1	0.8	3/16
PSSK	Screen separation kit, heat-shrink for 3-core cable	1	1.0–1.1	3/45
TSH	Branch seal kit	1	0.3–1.0	3/46
PC 630/250	Parallel coupling piece	3	3.0	3/16
JP 250	Earthing device, 250 A	1	2.7	3/16
CU 250	Coupling piece between two cable connectors, 250 A	1	0.2	3/16
MA 250	Measurement adapter, 250 A	1	0.3	3/16